

15mm thickness 1:2 cement-sand mortar hand < 1:10 gradient

200mm thickness C20 concrete tapering with 150mm thickness detritus tamping with soil

400mm thickness reinforcing steel bar and concrete, double two way, $\phi 12@200$ (horizontal steel)

100mm thickness C10 plain concrete underlaid

embed PVC pipes (access to pound house, diameter 30)

nozzle not shutted by cement, water forbidden coming into pipes. reserve one steel wire in the pipe to facilitate threading

Design	Audit	Shanhe Scale Co.Ltd.	
Draw	Audited	SCS - 3 m x 15m	Page 2
Correct	Date	Pit Foundation Draw	Page 1

M-M1 Cutaway Drawing

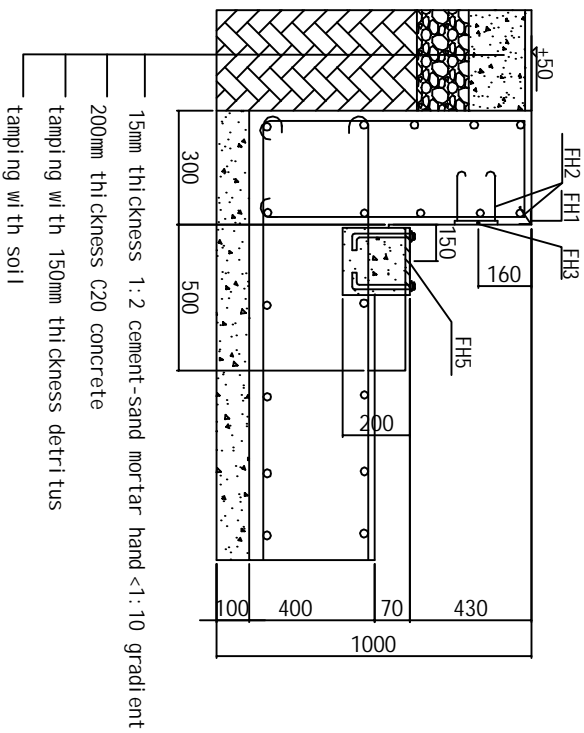

M-M2 Cutaway Drawing

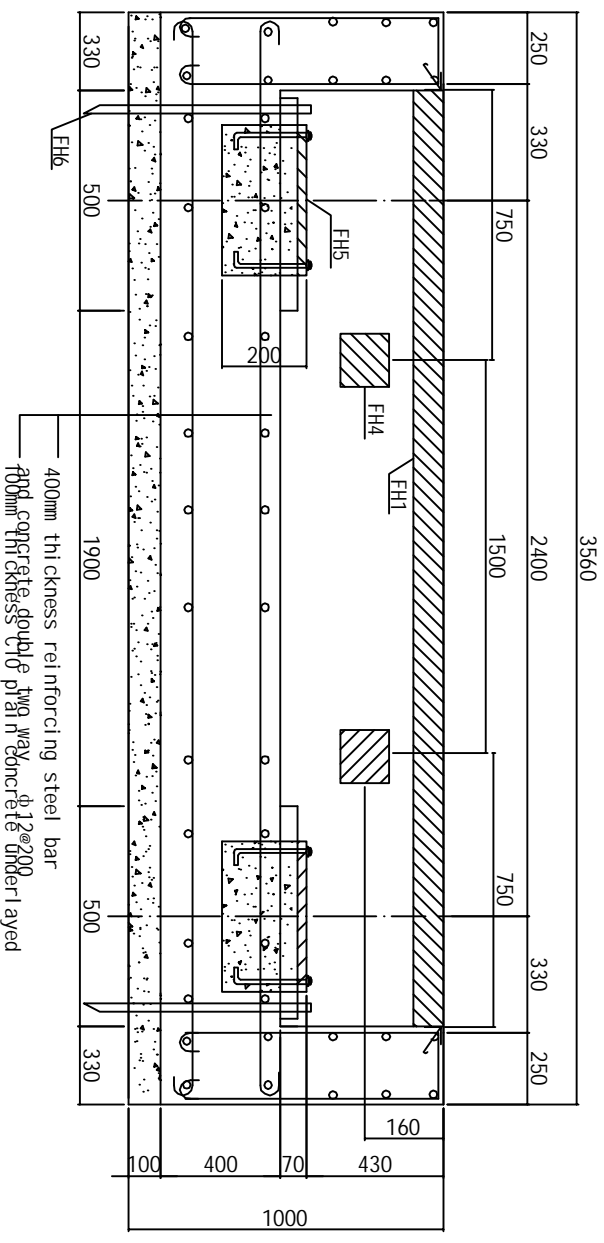

Remark

Symbol	Symbol	Explanation
	FH1	square steel (50 * 50 * 5mm)
	FH2	100x \varnothing 8 round steel bended to hooks
	FH3	Limit board (6*150*150mm) welding 4PCS FH2
	FH4	Specification of Limit board same as FH3 embedding 4PCS
	FH5	16*300*300mm of Load-bearing plate welding 4 PCS M4*150 bolt to fix
	FH6	Conductive pole, dimension $\geq \varnothing 12$, length ≥ 1250 mm

- All figures in the pictures are millimeter for the unit, height of natural floor ± 0
- Designed foundation bearing capacity $\geq 60\text{kn/m}$
- Concrete \pm C20, "Hoop steel" or reinforcing steel bar should be round steel, others whorl steel, underlay C10 concrete 100mm thickness
- Reinforce foundation according to carrying capacity of local soil and water level to avoid the foundation to go down, our pictures are just for your reference.
- Relative error of centre of each bearing plate (front and back, left and right, diagonal) ≤ 10 mm
- Surface of every bearing plate at the same level, error ≤ 3 mm, suggesting bearing plates irrigated twice to keep accuracy.
- Embedding hollow plastic pipes at the same time with foundation construction.
- The foundation place should be higher in the middle, lower at both sides to facilitate drainage (suggesting drainage holes use $\varnothing 150$ pipes' single-hole or porous)
- Conductive pole embedded next to foundation, and some buried near the pound house, indicator separately grounding (dimension of conductive pole $\geq \varnothing 12$, depth of embedding ≥ 1200 mm, outer from cement ground 50mm).

Design	Audit	Shanhe Scale Co. Ltd.	
Draw	Audited		SCS- 3 m x 15 m
Correct	Date		Pit Foundation Draw
			Page 2