

Design	Audit	Shanhe Scale Co.Ltd.	
Draw	Auditted	SCS- 3.2 m X 16m	Page 2
Correct	Date	Pit Foundation Draw	Page 1

M-M1 Cutaway Drawing

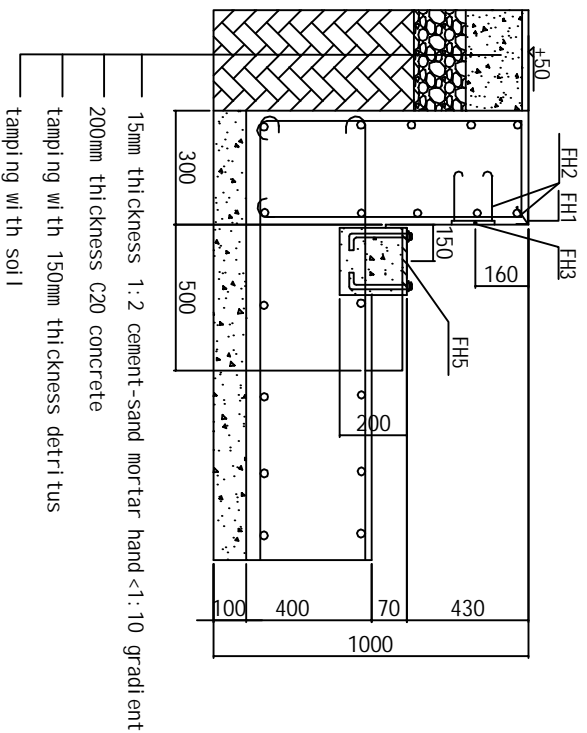

M-M2 Cutaway Drawing

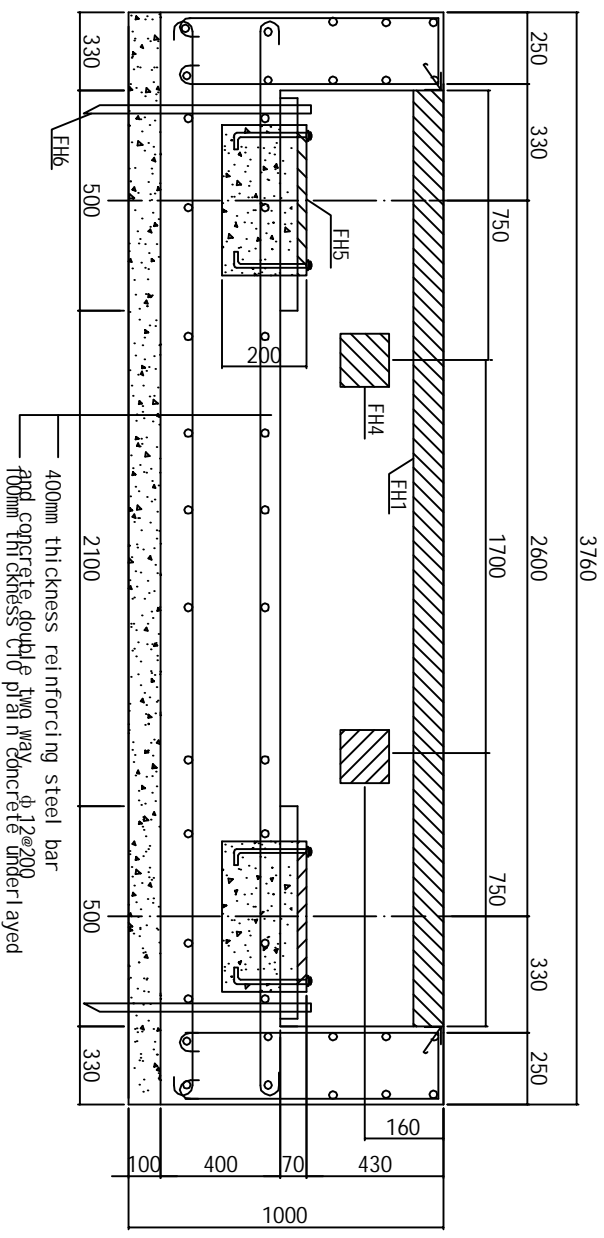

Symbol	Symbol	Explanation
	FH1	square steel (50 *50*5mm)
	FH2	100x8 round steel bended to hooks
	FH3	Limit board (6*150*150mm) welding 4PCS
	FH4	Specification of limit board same as FH3 embedding 4PCS
	FH5	16*300*300mm of load-bearing plate welding 4 PCS M4*150 bolt to fix
	FH6	Conductive pole, dimension $\geq \phi 2$, length ≥ 1250 mm

Remark

- All figures in the pictures are millimeter for the unit, height of natural floor ± 0
- Designed foundation bearing capacity $\geq 60\text{kn/m}$
- Concrete $\pm C20$, "Hoop steel" of reinforcing steel bar should be round steel, others whorl steel, underlay C10 concrete 100mm thickness
- Reinforce foundation according to carrying capacity of local soil and water level to avoid the foundation to go down, our pictures are just for your reference.
- Relative error of centre of each bearing plate (front and back, left and right, diagonal) ≤ 10 mm
- Surface of every bearing plate at the same level, error ≤ 3 mm, suggesting bearing plates irrigated twice to keep accuracy.
- Embedding hollow plastic pipes at the same time with foundation construction.
- The foundation place should be higher in the middle, lower at both sides to facilitate drainage (suggesting drainage holes use $\phi 150$ pipes' single-hole or porous)
- Conductive pole embedded next to foundation, and some buried near the pound house, indicator separately grounding (dimension of conductive pole $\geq \phi 12$, depth of embedding ≥ 1200 mm, outer from cement ground 50mm).

Design	Audited	Shanhe Scale Co. Ltd.	
Draw			SCS- 3.2 m x 16 m
Correct	Date		Pit Foundation Draw